



# LEADER CHUCK SYSTEMS

*Practical answers to workholding problems*

## LEADER MultiVice MMCC

The Leader MultiVice MMCC in-line multi-jaw vice system significantly increases the workholding capacity of vertical and horizontal machining centres, milling machines and grinders on long-run, high-volume applications.

MultiVice MMCC is an ultra-flexible, cost-efficient vice system that accommodates a high number of components at one time on the same table. Instead of locating and gripping components against centrally-fixed jaws, it comprises a series of in-line 'Dual Action' vice jaws located on the sub-plate with fixed dowel pins. Each Dual Action vice jaw has an integral moving jaw with 3 mm of clamping stroke.

A permanently fixed jaw provides the datum. Each MMCC is subsequently fixed and positioned by dowel pins 'behind' the previous jaw at a distance dictated by the workpiece size. This eliminates compound gripping force and generates a very stable and highly accurate vice system.

The quick change false jaws feature an innovative design of positive dovetail location for continuous repeatability, and are available in a variety of materials. A flush-fit between jaw and body prevents the ingress of swarf.

Secure locking/unlocking is achieved with just a quarter turn of the key. MultiVice MMCC provides these additional benefits:

- Workpiece capacity limited only by machine table size;
- Rigid clamping gives increased tool life through less vibration;
- No component lift when clamping;
- Maximised use of the z axis through its low height; and
- High clamping pressure.



### MULTIVICE MMCC

#### Dimensions (mm)

	Key	VICE TYPE	
		60	
		Dual Action Jaw	Fixed Jaw
Width	A	62	62
Height	B	27	26
Minimum Length*	C	62	51
Tenon Width	D	N/A	12
Tenon Depth	E	N/A	4
Fixing Screw Centres	G	18	18
Fixing Screws	K	M10	M10
Jaw Stroke	L	3	N/A
Dowel Pin Diameter	M	6	N/A
Dowel Pin Length	N	8.5	N/A
Operating Key	R	5	N/A
Blank Jaw Length	X	12	12
Blank Jaw Width	Y	62	62
Blank Jaw Height	Z	25.5	25.5
Maximum Jaw Grip	da/N	710	N/A

\* Without Blank Jaws

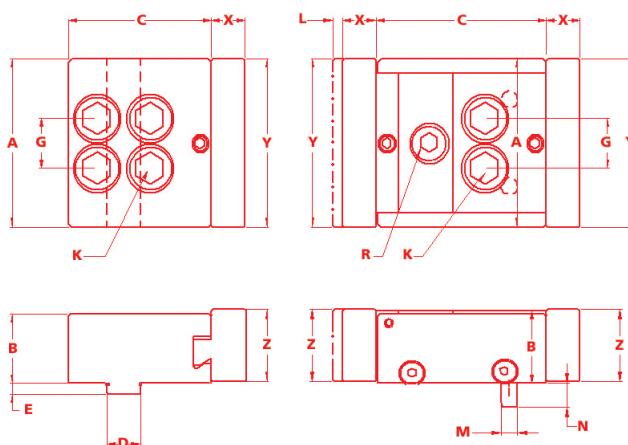

**LEADER CHUCK SYSTEMS LTD** Specialists in workholding

Century Park Birmingham B9 4NZ England

Tel: +44 (0)121 771 4843 Fax: +44 (0)121 771 0966



For the complete Leader product range visit [www.leaderchuck.com](http://www.leaderchuck.com)